

3785 WILSHIRE BLVD, LOS ANGELES, CA 90010

# SOLAIR RETAIL

FOR LEASE



**MARK HONG**

Cal Dre #01067529

213.251.9000

[markhong@korusre.com](mailto:markhong@korusre.com)



## AERIAL MAP

## SOLAIR RETAIL

3785 WILSHIRE BLVD



PARIS BAGUETTE



## MADANG PLAZA



S Western Ave (+42,684 VPD)





# PROPERTY SUMMARY



## ADDRESS

3785 Wilshire Blvd  
Los Angeles, CA 90010



## LEASE RATE

\$3.00 + NNN



## BUILDING SIZE

333,324 Sq. Ft.  
41,000 Sq. Ft.  
(Retail)



## PARKING

150 Parking  
Spaces  
(3.7 per 1,000)

# PROPERTY INFORMATION

- Food/Restaurant use available
- NEC of Wilshire Boulevard and Western Ave.
- Retail fronts the entire block of Western Ave.
- 150 parking spaces for retail in the underground garage.
- Adjacent to MTA Metro Station (Purple Line.)
- One of the highest-density neighborhoods in the U.S.  
(±661,694 residents within a three-mile radius)

# CO-ANCHORED BY



The information above has been obtained from sources believed reliable. While we do not doubt its accuracy, we have not verified it and make no guarantee, warranty or representation about it. It is your responsibility to independently confirm its accuracy and completeness.



3785 Wilshire Blvd, Los Angeles, CA 90010

# SITE PLAN - GROUND FLOOR

## AVAILABILITY:

103 AB: 1,604 Sq. Ft.

104 ABC: 2,773 Sq. Ft.

105AB: 2,770 Sq. Ft.

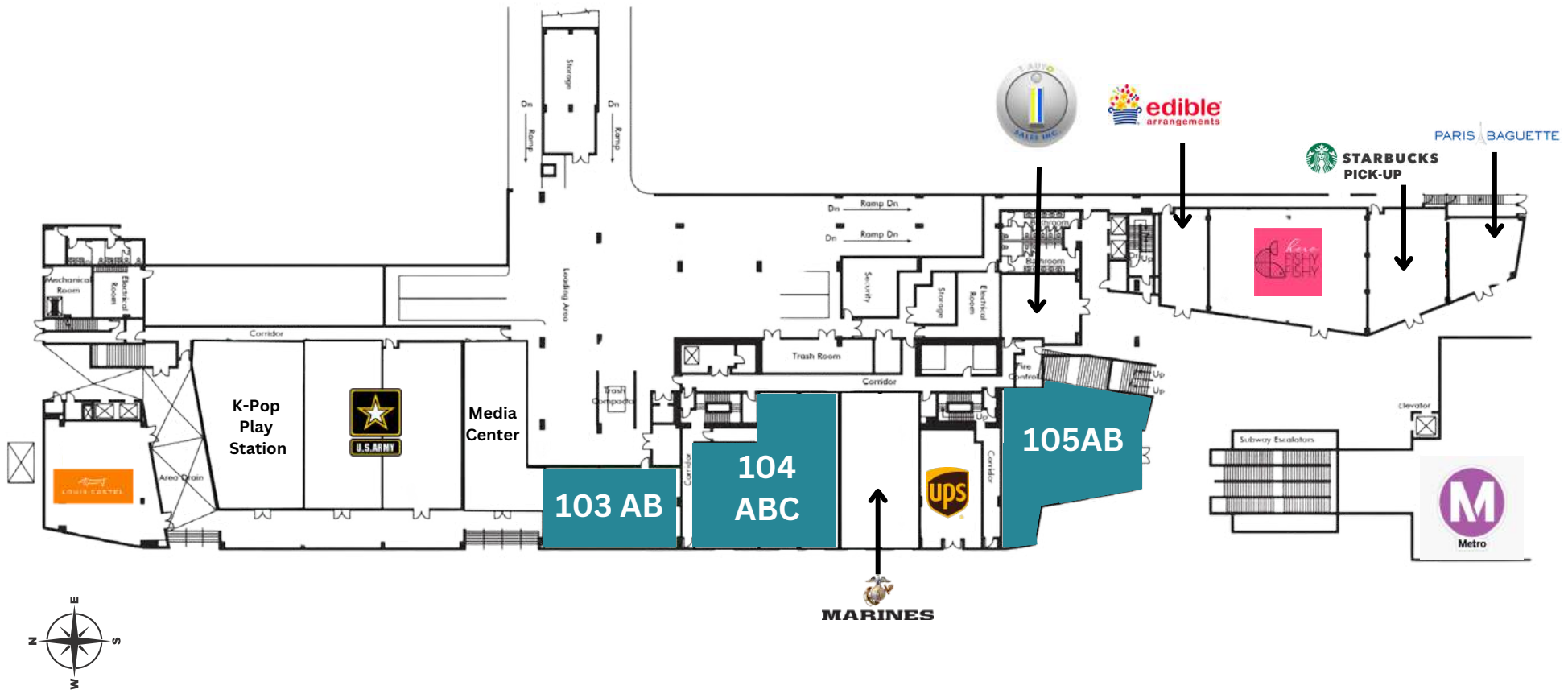

The information above has been obtained from sources believed reliable. While we do not doubt its accuracy, we have not verified it and make no guarantee, warranty or representation about it. It is your responsibility to independently confirm its accuracy and completeness.

3785 Wilshire Blvd, Los Angeles, CA 90010

# SITE PLAN - SECOND FLOOR

AVAILABILITY: 1,291 SQ. FT.

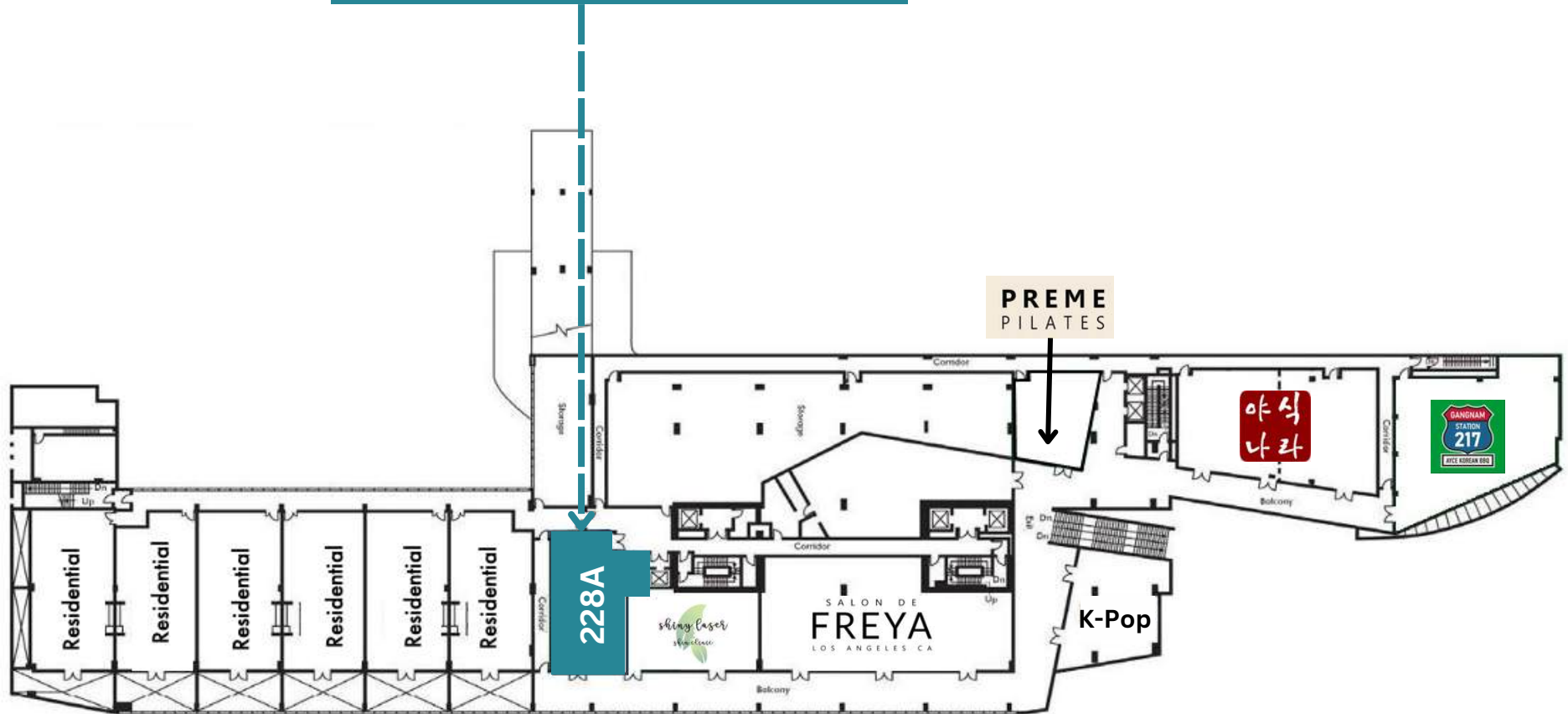

The information above has been obtained from sources believed reliable. While we do not doubt its accuracy, we have not verified it and make no guarantee, warranty or representation about it. It is your responsibility to independently confirm its accuracy and completeness.

3785 Wilshire Blvd, Los Angeles, CA 90010





## PROPERTY IMAGES





The information above has been obtained from sources believed reliable. While we do not doubt its accuracy, we have not verified it and make no guarantee, warranty or representation about it. It is your responsibility to independently confirm its accuracy and completeness.

**3785 Wilshire Blvd, Los Angeles, CA 90010**



# DEMOGRAPHICS

	1 MILE	3 MILES	5 MILES
 <b>Population</b>			
2023 Estimated Population	110,059	661,694	1,228,692
2028 Projected Population	109,448	654,703	1,213,887
2010 Census Population	101,707	628,702	1,177,191
 <b>Households</b>			
2023 Estimated Households	43,213	248,172	473,906
2028 Projected Households	42,824	245,439	467,868
2010 Census Households	40,481	235,118	453,229
 <b>Income</b>			
2023 Estimated Average Household Income	\$68,189	\$76,267	\$87,545
2023 Median Household Income	\$49,092	\$52,357	\$59,626



3785 Wilshire Blvd, Los Angeles, CA 90010

The information above has been obtained from sources believed reliable. While we do not doubt its accuracy, we have not verified it and make no guarantee, warranty or representation about it. It is your responsibility to independently confirm its accuracy and completeness.