

3785 WILSHIRE BLVD, LOS ANGELES, CA 90010

SOLAIR RETAIL

FOR LEASE



MARK HONG

Cal Dre #01067529

213.251.9000

markhong@korusre.com

AERIAL MAP

SOLAIR RETAIL

3785 WILSHIRE BLVD



PARIS BAGUETTE



MADANG PLAZA



S Western Ave (+42,684 VPD)



PROPERTY SUMMARY



ADDRESS

3785 Wilshire Blvd
Los Angeles, CA 90010



LEASE RATE

\$3.00 + NNN



BUILDING SIZE

333,324 Sq. Ft.
41,000 Sq. Ft.
(Retail)



PARKING

150 Parking
Spaces
(3.7 per 1,000)

PROPERTY INFORMATION

- Food/Restaurant use available
- NEC of Wilshire Boulevard and Western Ave.
- Retail fronts the entire block of Western Ave.
- 150 parking spaces for retail in the underground garage.
- Adjacent to MTA Metro Station (Purple Line.)
- One of the highest-density neighborhoods in the U.S.
(±661,694 residents within a three-mile radius)

CO-ANCHORED BY



The information above has been obtained from sources believed reliable. While we do not doubt its accuracy, we have not verified it and make no guarantee, warranty or representation about it. It is your responsibility to independently confirm its accuracy and completeness.



3785 Wilshire Blvd, Los Angeles, CA 90010

SITE PLAN - GROUND FLOOR

AVAILABILITY:

103 AB: 1,604 Sq. Ft.

105AB: 2,770 Sq. Ft.

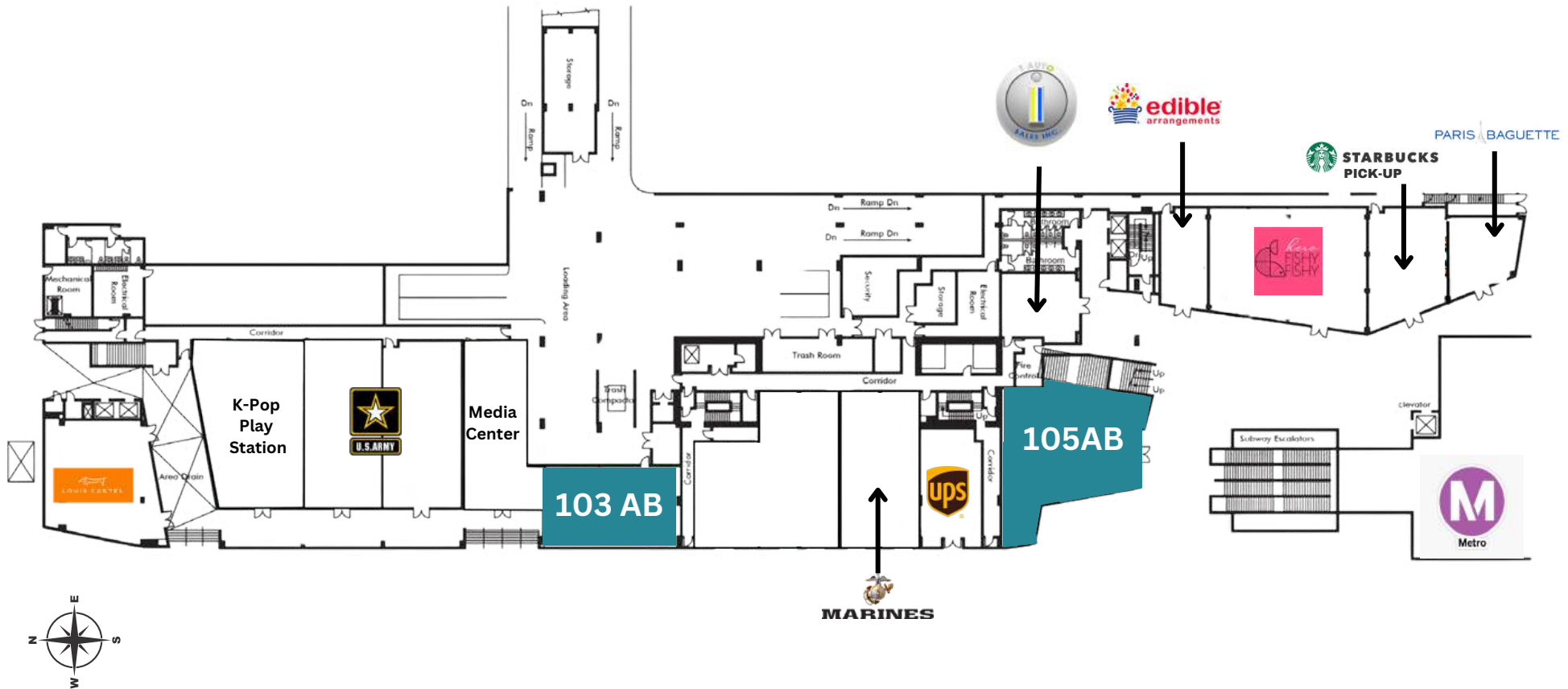

The information above has been obtained from sources believed reliable. While we do not doubt its accuracy, we have not verified it and make no guarantee, warranty or representation about it. It is your responsibility to independently confirm its accuracy and completeness.

3785 Wilshire Blvd, Los Angeles, CA 90010

SITE PLAN - SECOND FLOOR

AVAILABILITY: 1,291 SQ. FT.

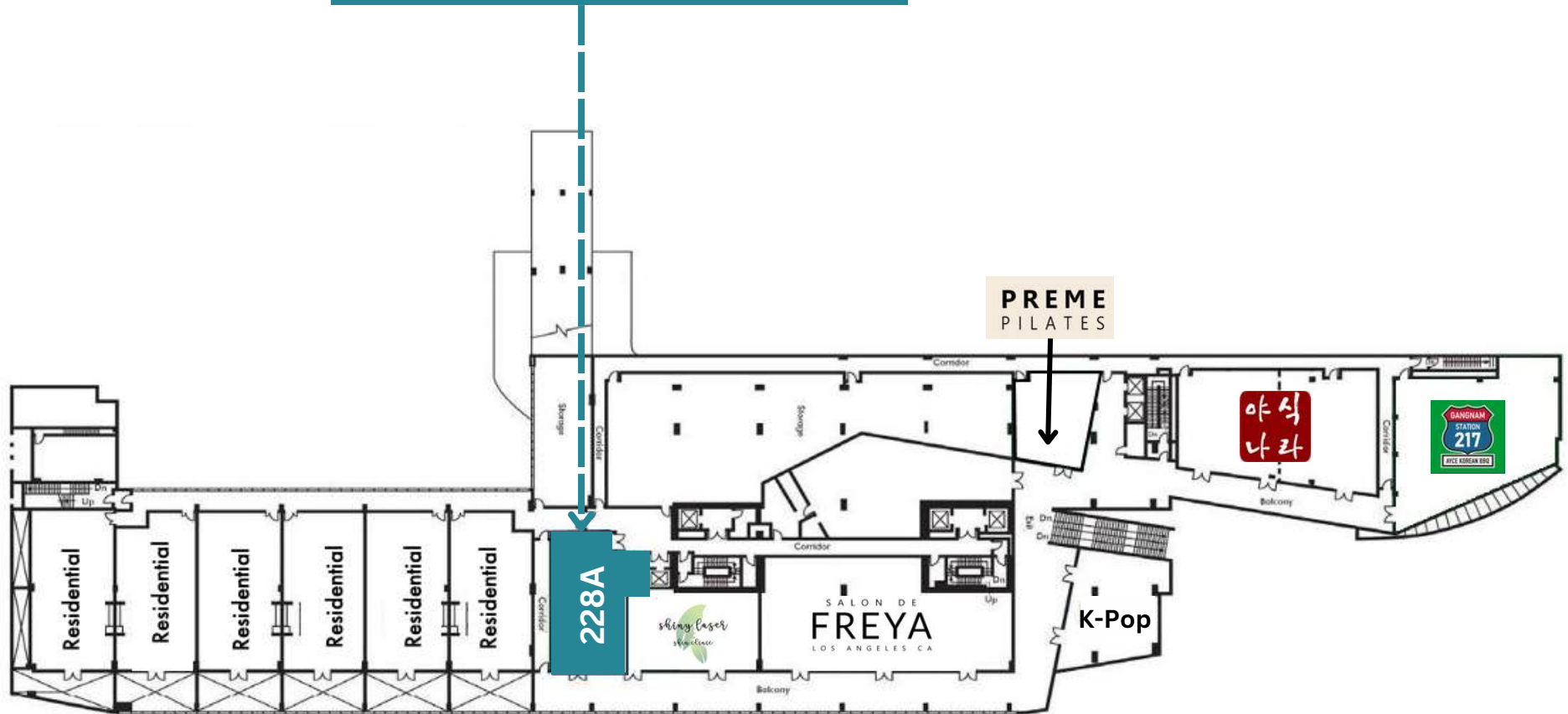

The information above has been obtained from sources believed reliable. While we do not doubt its accuracy, we have not verified it and make no guarantee, warranty or representation about it. It is your responsibility to independently confirm its accuracy and completeness.

3785 Wilshire Blvd, Los Angeles, CA 90010





PROPERTY IMAGES



The information above has been obtained from sources believed reliable. While we do not doubt its accuracy, we have not verified it and make no guarantee, warranty or representation about it. It is your responsibility to independently confirm its accuracy and completeness.

3785 Wilshire Blvd, Los Angeles, CA 90010

DEMOGRAPHICS

	1 MILE	3 MILES	5 MILES
 Population			
2023 Estimated Population	110,059	661,694	1,228,692
2028 Projected Population	109,448	654,703	1,213,887
2010 Census Population	101,707	628,702	1,177,191
 Households			
2023 Estimated Households	43,213	248,172	473,906
2028 Projected Households	42,824	245,439	467,868
2010 Census Households	40,481	235,118	453,229
 Income			
2023 Estimated Average Household Income	\$68,189	\$76,267	\$87,545
2023 Median Household Income	\$49,092	\$52,357	\$59,626



3785 Wilshire Blvd, Los Angeles, CA 90010

The information above has been obtained from sources believed reliable. While we do not doubt its accuracy, we have not verified it and make no guarantee, warranty or representation about it. It is your responsibility to independently confirm its accuracy and completeness.